

9-11-70

Dist.

Subdivision

NUMBER 5847

COUNTY

Kailua Park Sub #2

Final
7/12/77

Address Lot 4 Blk 7 Elm & Deer

BUILDING			PLUMBING			ELECTRICAL		
Builder	owner		Plumber			Electrician		
Owner	Charles E. Turkington			Date	Insp.		Date	Insp.
Setback — Front	Side	Rear	Grnd Plmbg.			Rgh. Partial		
Residential <input type="checkbox"/>	Commercial <input type="checkbox"/>		Top Out			Rgh. Complete	<i>✓ 10/13/70</i>	<i>CALL</i>
	Date	Insp.	Sewer System	<i>HOLDING TANK 11/4/70</i>	<i>CALL</i>	Cond. Partial		
Forms	<i>10/4/70</i>	<i>CALL</i>	Water Service			Cond. Complete		
Frame	<i>✓ 10/13/70</i>	<i>CALL</i>						
Scratch Stucco			Gas Line Test	<i>11/4/70</i>	<i>CALL</i>			
Brown Stucco			Gas Tag #					
Bond Beam	<i>10/7/70</i>	<i>CALL</i>				Final Tag #	<i>0983</i>	
Fireplace								
Final	<i>7/12/77</i>	<i>CALL</i>	Final	<i>7/12/77</i>	<i>CALL</i>	Final	<i>7/12/77</i>	<i>CALL</i>

Remarks: S.F.D. RELOCATION

HEATING And COOLING

Contractor	Date	Insp.
	<i>Plan + plot plan enc.</i>	
Heating Ducts		
Heater		
Rough Piping		
Flues		
Final		
Cooling Ducts		
Compressors		
Rough Piping		
Final		

100.00'

100.00'

SITE IS ESSENTIALLY FLAT

24'-6"

15'-0"

35'-0"

18'-0"

28'-0"

20'-0"

20'-0"

1 1/2" GRAVEL

2500 GAL SAND
HOLDING TANK

16" ϕ x 22'-0" S.I.
CULVERT

EDGE OF PAVEMENT

DEER AVENUE

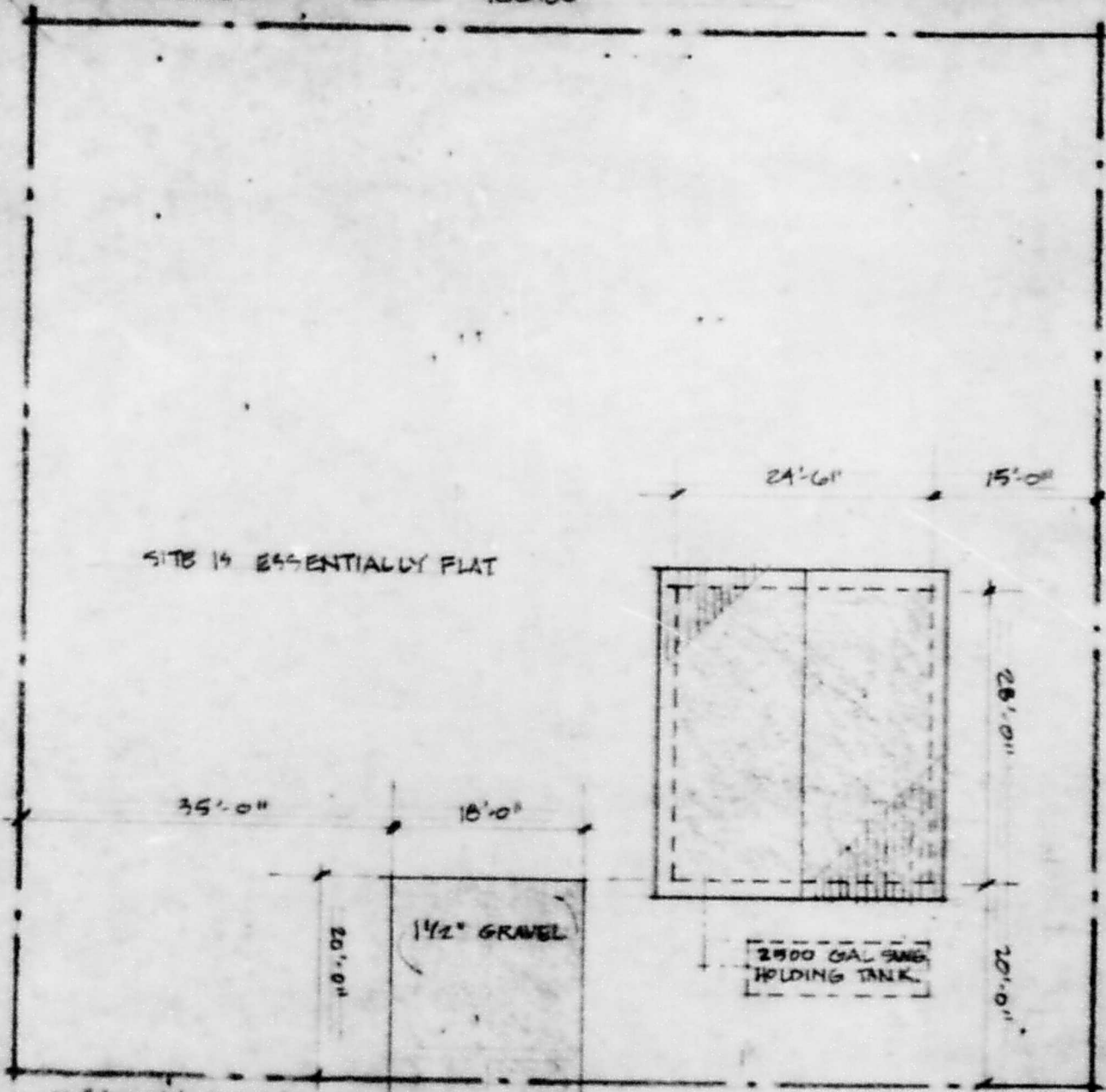
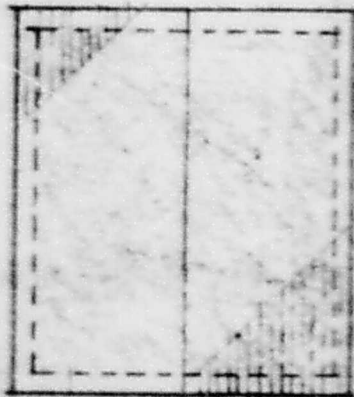

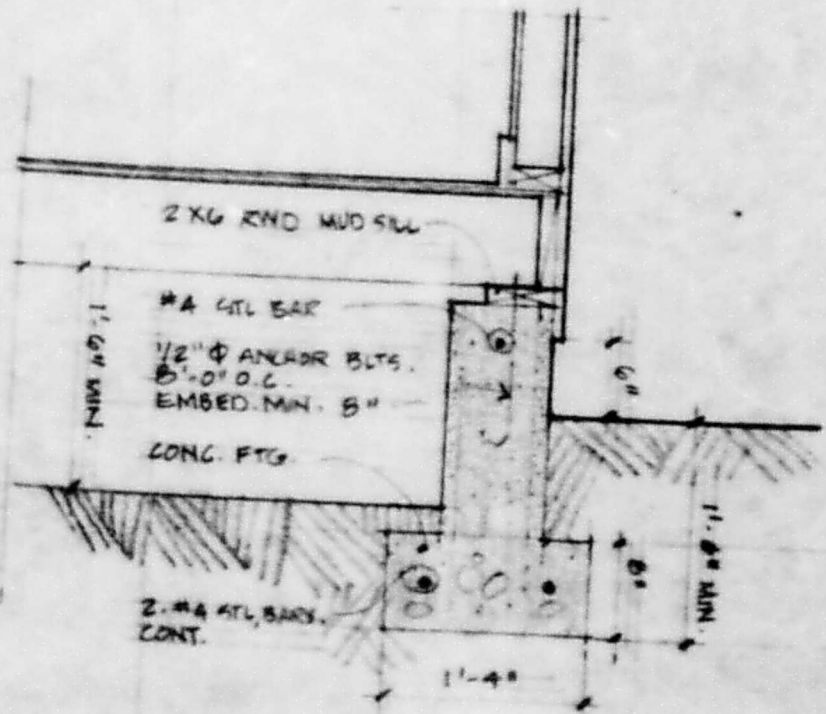

A TYP. SECTION THRU FOUNDATION
 3/4" = 1'-0"

DIMENSION TO MATCH EXIST. BUILDING.

EQ. EQ. EQ. EQ. EQ.

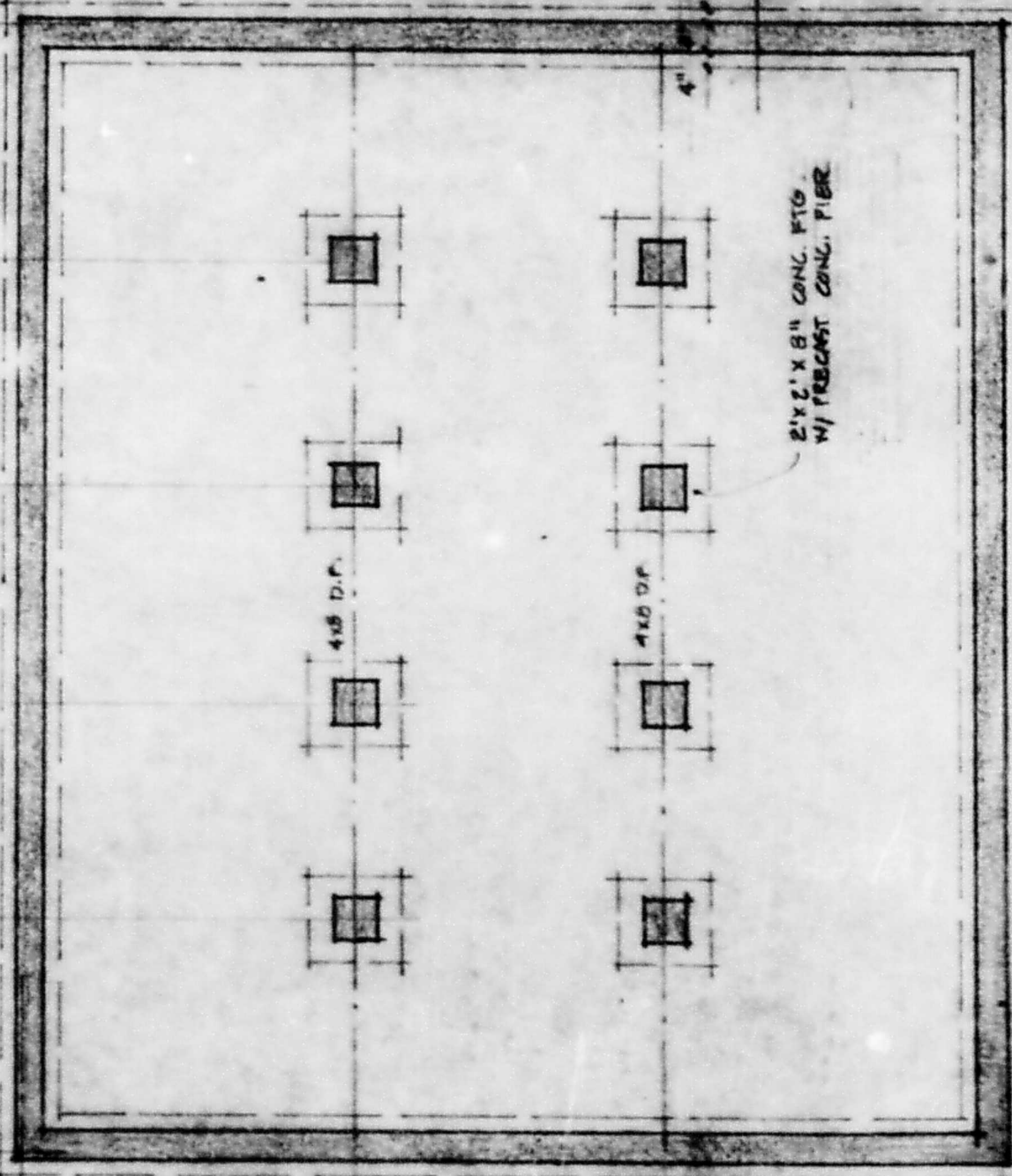

2'x2'x8" CONC. FTG.
W/ PRECAST CONC. PIER

EQ. EQ. EQ.

DIMENSION TO MATCH EXIST. BUILDING

FOUNDATION PLAN 1/4" = 1'-0"

INSPECTION REQUEST

CALLED IN -

PROMISED -

day / date/am-pm

day / date/am-pm

PERMIT NO. 5847

Inspector _____

Owner _____ Contractor _____

Address _____

Nearest _____

Cross Street _____ Sub. _____

BUILDING -

Footing/Fndtn _____	Girder/Joist _____
Frame _____	Roof Underlay _____
Fireplace _____	Roof Nailing _____
Firewall _____	FINAL Structure _____
Shearwall _____	
Bond Beam _____	

ELECTRICAL -

Power Pole _____	Underground _____
Partial Elec. _____	Info. Elec. _____
Rough Elec. _____	FINAL Elec. _____
Temp. Power _____	

PLUMBING -

Ground _____	X Gas Test 11/4/70 <i>CDK</i>
Info. Plmb. _____	FINAL Plmb. _____
Topout _____	

OTHER -

Sign Fndtn _____	Sewer (#) _____
FINAL Sign _____	Septic Tank _____
Encrchmnt (#) _____	

ADDITIONAL INFORMATION -

holding tank
OK. - 11/4/70 - CDK

INSPECTION REQUEST

CALLED IN -

PROMISED -

day

date/am-pm

day

date/am-pm

PERMIT NO.

5547

Inspector _____

Owner _____

Contractor _____

Address _____

Nearest _____

Cross Street _____

Sub. _____

BUILDING -

Footing/Fodtn _____

Girder/Joist _____

 Frame

Fireplace _____

Roof Underlay _____

Firewall _____

Roof Nailing _____

Shearwall _____

FINAL Structure _____

Bond Beam _____

ELECTRICAL -

Power Pole _____

Underground _____

Partial Elec. _____

Info. Elec. _____

 Rough Elec.

Temp. Power _____

FINAL Elec. _____

PLUMBING -

Ground _____

Gas Test _____

Info. Plmb. _____

FINAL Plmb. _____

Topout _____

OTHER -

Sign Fndtn _____

Sewer(#) _____

FINAL Sign _____

Septic Tank _____

Enchrmt(#) _____

ADDITIONAL INFORMATION -

INSPECTION REQUEST

CALLED IN -

PROMISED -

1 10-1
day date/am-pm1 10-2
day date/am-pm

PERMIT NO. 5847

Inspector Blaney

Owner (W. Kingston) Contractor [Signature]

Address _____

Nearest _____

Cross Street _____ Sub. _____

BUILDING -

Footng/Fndtn	10/1/72 Call	Slider/Joist
Frame		Roof Underlay
Fireplace		Roof Nailing
Firewall		FINAL Structure
Sheetrock		
Bond Beam		

ELECTRICAL -

Power Pole	Underground
Partial Elec.	Info. Elec.
Rough Elec.	FINAL Elec.
Temp. Power	

PLUMBING -

Ground	Gas Test
Info. Plab.	FINAL Plab.
Topout	

OTHER -

Sign Fndtn	Sewer()
FINAL Sign	Septic Tank
Encrment()	

ADDITIONAL INFORMATION -

INSPECTION REQUEST

CALLED IN -

PROMISED -

day

date/am-pm

day

date/am-pm

PERMIT NO.

5847

Inspector

Owner

Contractor

Address

Nearest

Cross Street

Sub.

BUILDING -

Footing/Fndtn

Frame

Fireplace

Firewall

Shearwall

Bond Beam

Girder/Joist

Roof Underlay

Roof Nailing

FINAL Structure

ELECTRICAL -

Power Pole

Partial Elec.

Rough Elec.

Temp. Power

Underground

Info. Elec.

FINAL Elec.

PLUMBING -

Ground

Info. Plmb.

Topout

Gas Test

FINAL Plmb.

OTHER -

Sign Fndtn

FINAL Sign

Encrchmnt (#)

Sewer (#)

Septic Tank

ADDITIONAL INFORMATION -

INSPECTION REQUEST

CALLED IN - 7-12-71 PROMISED - 7-12-71
 day date/am-pm day date/am-pm

PERMIT NO. 5847 Inspector _____

Owner Kupka - Contractor _____

Address _____

Nearest _____

Cross Street _____ Sub. _____

BUILDING -

Footing/Fndtn _____	Girder/Joist _____
Frame _____	Roof Underlay _____
Fireplace _____	Roof Nailing _____
Firewall _____	FINAL Structure _____
Shearwall _____	
Bond Beam _____	

ELECTRICAL -

Power Pole _____	Underground _____
Partial Elec. _____	Info. Elec. _____
Rough Elec. _____	FINAL Elec. _____
Temp. Power _____	

PLUMBING -

Ground _____	Gas Test _____
Info. Plmb. _____	FINAL Plmb. _____
Topout _____	

OTHER -

Sign Fndtn _____	Sewer (# _____)
FINAL Sign _____	Septic Tank _____
Encrchmnt (# _____)	

ADDITIONAL INFORMATION -

Good

APPLICATION FOR INSPECTION PRIOR TO RELOCATION OF BUILDING

58A-069

APPLICANT Charles E. Huntington PHONE NO. 415-981-0900

MAIL ADDRESS 1250 California Street, Suite 202, San Francisco, CA 94109

APPLICATION NO. 11-
 DATE 9/27/70
 FEE 10.00
 RECEIPT NO. 8060

ADDRESS OF BUILDING TO BE MOVED 1250 California Street, Suite 202, San Francisco, CA 94109

Locality Haywood

Nearest cross Street Lodge Drive and Highway 89

Building occupancy Residential

Type of Construction H.W.F. wood frame

Propose to move building to Lot 4 Block 7 Subdivision #2

Locality Kashua Park Use Residential

Sq. ft. _____
 No. stories 2
 Zone R-1
 Parcel No. 2
 Lot size 100 x 100

NOTE: THIS APPLICATION IS NOT A PERMIT TO MOVE ANY BUILDING OR A PERMIT FOR ANY CONSTRUCTION. IT IS AN APPLICATION FOR THE REQUIRED PRELIMINARY INSPECTION OF THE BUILDING TO BE MOVED.

A building permit to move the above described building to the above described location will be issued subject to the following conditions:

1. A Sanitation Permit must first be obtained from the El Dorado County Health Department for the construction of a sewage disposal system on the proposed parcel of land.
2. The use and occupancy of the building must conform with the zoning regulations for the proposed parcel of land or a Variance must be obtained from the City of South Lake Tahoe Planning Commission allowing the requested use.
3. THE FOLLOWING MODIFICATIONS AND ALTERATIONS WILL BE MADE BEFORE THE BUILDING IS OCCUPIED

(a) BUILDING clean span Rafters to have 2x8 added each side from Plate to ridge

(b) PLUMBING Permit to 1967 U.P.C.

(c) ELECTRICAL: Permit to 1968 NEC

Inspected by: CAK DATE 9-17-70

I hereby acknowledge that I have read this application and state that the information given is correct. I agree to comply with the corrections listed hereon or attached hereto, and with all City Ordinances and State Laws regulating building construction. I certify that I am the legal owner of the parcel of land for which this application is being made.

Signature of Applicant: Charles E. Huntington