

DATE December 2, 1982

ADDRESS Lot 44 (1540) Horace Greeley

LOCATION Sierra Meadows #2

OWNER Agustin Chacon

BUILDER John S. Graham Entr., Inc.

TYPE OF STRUCTURE

SFD/Gar/Deck

LCC - #7

NUMBER

25-312-17

Final 10/14/83
19487-T

REMARKS

INSPECTIONS:

Temp. power:

P.G.E. Notified:

Plot Plans: *filled in folders*

Septic final:

Health Dept. I.D. finalized:

Permit released: *Contd 12-3-82*

Final all:

10-14-83 A. Sierra Pac. of final
10-17-83 A. Comm of final

Multiple horizontal lines for additional notes or signatures.

EL DORADO COUNTY BUILDING DEPARTMENT

CONSTRUCTION PERMIT

T

19487

1982 ALLOCATION

Bldg
 Plumb
 Elec
 Mech
 Gas
 Sewage
 Mobile Home Site

Date December 2, 1982
 Owner Agustin Chacon
 Address Box 872 9511 Road 239
 City & State Terra Bella, CA
 Zip 93270 Telephone 209-535-4979
 Contractor John S. Graham Entr., Inc.
 Address Box 9535
 City South Lake Tahoe, CA
 Zip 95731 Telephone 541-0431
 Contractor's License No. 350450 Class B
 Workmen's Comp No. On File
 Lending Agency _____
 Branch _____

Assessor's Parcel No. 25-112-17
 Section _____ Township _____ Range _____
 Parcel Map No. _____ County Rd _____
 No. of Bedrooms _____ Parc Test _____
 Water Source _____ Supplier _____
 Public Sewer _____

PLANNING DEPARTMENT USE

Lot Size _____ Zone _____
 Min. Setbacks: FR _____ RS _____ LS _____ R _____
 House No. _____
 School Dist. _____
 Super. Dist. _____ C.T. _____
 Variance or Spec Use No. _____ Date 1/1

DRIVING DIRECTIONS

Lot 44 (JUST NO. 1982) Horace Greeley, South Lake Tahoe, CA

Pioneer Trail, right on Black Earth to Main Road to Horace Greeley

Permission is hereby granted to build, occupy and use as specified, the building or structure listed below:

DESCRIPTION	GROUP & DIV.	TYPE RATING	SQUARE FEET	COST/SQ.FT.	VALUATION
S.F.D.	B-3	V1	1400	43.95	\$ 61,530
Garage		V1	400	10.92	\$ 4,368
Deck		V3	210	5.72	\$ 1,201

Type of Heating Gas - 37A Wall Data Code _____ Total Valuation \$ 67,099

Remarks and Conditions: P/C 11/27, 12/7/82 \$541.00-\$75.00-\$480.00

APPROVALS:
 STPUD: EC 11/23/82
 WATER: _____
 PUBLIC WORKS: _____
 CIVIL: JC 10/28/82
 TRPA: MS 11/2/82
 PLANNING: OMB 12/1/82 LCC - 87

CONSTRUCTION \$ _____
 M.H. SITE _____
 SEWAGE _____
 ENCROACHMENT _____
 ISSUANCE _____
 PENALTY _____

NOTE: PERMIT EXPIRES IF FOUNDATION IS NOT LAID AND APPROVED WITHIN SIX MONTHS FROM MAY 1, 1983 AND/OR IF WORK IS SUSPENDED MORE THAN SIX MONTHS THEREAFTER

TOTAL \$ _____

RECEIPT NO. _____

This Work Permit Authorized and permit issued by William Horacraft Date _____ Clerk M. Patton

STRUCTURAL	DATE	INSP	ELEC	DATE	INSP	PLUMB	DATE	INSP	MECH	DATE	INSP
Setbacks-Found	6-17-83	W	U-Ground	8-17-83	W	U-Ground Waste	8-17-83	W	Heat Duct	8-22-83	W
Slab			Rough	8-23-83	W	Rough	8-17-83	W	Cold Air Duct		
Frame	8/22/83	W	Main Panel			Vents			Heater Furnace		
Lath			Well Pump			Sewer			Flues		
Sheetrock	8/24/83	W	Sub Panel			Water Supply			Ex. Fan.		
Stucco			Base Heat			Int. P.V. Pipe			A/C Unit		
Roof Deck			Fixtures			Tub Shower			Hood		
Roof Cover			Pedestal			W/M			Vents		
Stair-Rail						Gas Pipe					
U-Floor Vent											
Attic Vent											

CORRECTION NOTICE POSTED

Mech.	Date	Insp.	M/H	Date	Insp.
Deck-rail			Site		
Fireplace Throat			Supp. Struct.		
Fireplace Roof			Ramada		
Swim. Pool					
Septic Tank					
Leach Line-Pit					
Rock & Pipe					
D-Box					

Date	Insp.	Approved	Insp.	Stop Work	Insp.

P.P. Tag # _____ T.P. Tag # _____
 Gas Tag # _____ Test # _____ Lbs.
 Final Meter Set Tag # _____

FINAL INSPECTION

INSP. _____ INSP. _____ INSP. _____ INSP. _____
 Bldg. _____ Mech. _____ Fireplace _____ Septic Sys. _____
 Elec. _____ M/H Site _____ Swim. Pool _____ E.R.C. _____
 Plumb. _____ Deck-Rail _____ Grading _____ Road Encl. 8/29/83

CERTIFICATE OF OCCUPANCY ISSUED _____ DATE 10/14/83 BY INSP [Signature]

COMMENTS: _____

July 1, 1983 Post, Girders, and Floor Test and House Gas Line Test WSM
SEPT. 6-83 Wall Assembly For wood stove Reduced clearances ok WSM
10-17-83 W. CPN of final
10-14-83 W. Sign Pac. of final

EL DORADO COUNTY BUILDING DEPARTMENT
APPLICATION FOR CONSTRUCTION PERMIT

1387
 Plan Check Number

Permit Number

*Transf. from 23-561-21
 1982 Allee*

APPLICANT TO COMPLETE

Date 11-23-82
 Owner AGUSTIN CHACON
 Mailing Address PO Box 872 9511 Road 239
 City & State Texas Bella Calit 93270
 Zip _____ Telephone 209-535-4979
 Contractor JOHN S BRANNAN F&T Inc
 Mailing Address PO Box 9535
 City & State SLT Calif
 Zip 95731 Telephone 5410431
 Class & License # B1 360460
 Workmen's Comp. No. on file
 Lending Agency _____
 Branch _____

Assessor's Parcel No. 25-312-17
 Section _____ Township _____ Range _____
 Parcel Map No. _____ County Road _____
 No. of Bedrooms _____ Perc. Test _____
 Water Source STPUD Supplier _____
 Public Sewer STPUD #17292

PLANNING DEPARTMENT USE	
Lot Size _____	Zone <u>TR4</u>
Min Setbacks: Front <u>20</u> RS <u>5</u> LS <u>5</u> Rear <u>15</u>	
House No. <u>1540 HORACE GREENE AVE</u>	
School Dist. <u>LAKE TABLE 'AMFIE'</u>	
Super. Dist. <u>2</u>	C.T. <u>305</u>
Variance or Special Use No. _____	Date <u>1-1</u>

PROPERTY ADDRESS and DRIVING DIRECTIONS: 131/2 K BENT To Hank about To Horace Lacey
LOT 44 HORACE GREENE SIERRA MENDOCINO #2

DESCRIPTION OF WORK

Permit For: Single Fam Mobile Home Make _____
 Electric _____ Amps 200 Size _____ State Mig. _____ Year _____
 Plumbing _____ Serial No. _____ / _____
 Type of Heating Forced Air with GAS. License No. _____ / _____
 LCC # _____ For Period of _____

OWNER/CONTRACTOR/AGENT-SIGN ON REVERSE SIDE OF APPLICATION

FOR OFFICE USE ONLY

APPROVALS	APP. BY	DATE	CC.	TYPE	SQ. FT.	COST	VALUATION
SEWER	Kerris O	11-23-82	R-3	IN	1900	43.99	61,586.00
WATER			M-1	IN	464	10.92	5,066.88
PUBLIC WKS.			DECK	IN	218	5.82	1,268.76
CTRPA	JANIS COIT	10-2-82					
TRPA	MARIE SERRICH	11-2-82					
PLANNING	ORCA	11/23/82					
					Total Valuation \$ <u>67,921.64</u>		

FEE'S
 Construction 468.00
 M.H. Site _____
 Sewage _____
 Encroachment _____
 Issuance _____
 Penalty _____
SUB TOTAL _____
 High School _____
 Elementary School _____
TOTAL FEES _____

543-75=
 Rec. By WSM Date DEC. 1-1982 P.C. # 57994 Fee Check For 75 Rec. No. 11

CONTRACTORS—OWNER/BUILDER

I hereby certify that I have read this application and that the information is correct. I agree to comply with all County Ordinances and State Laws relating to building construction.

1. LICENSED CONTRACTORS DECLARATION — I certify that I am licensed under provisions of Chapter 9 (commencing with Section 7000) of Division 3 of the Business and Professions Code, and my license is in full force and effect.

Date _____ Contractor _____
License Class & No. _____

2. OWNER—BUILDER DECLARATION — I hereby affirm that I am exempt from the Contractors' License Law, Business and Professions Code. (Section 7031.5) by one of the following:

- (a) I, as owner of the property, will do the work myself without hiring any employees, and the building or structure is not intended or offered for sale. (Proof of sale or offering for sale of the structure by the owner-builder within one year is presumptive evidence that such structure was undertaken for the purpose of sale). Complete Section #4 below. (Section 7031.5)
- (b) I, as owner, am contracting with local contractors to construct the project. (Section 7044)
- (c) I, as owner of the property, will employ workers with wages as their sole compensation. Complete Section #3 below.
- (d) I am exempt under Section _____ Reason _____

Date _____ Owner _____

3. WORKMEN'S COMPENSATION INSURANCE — I hereby affirm that I have a certificate of Workmen's Compensation Insurance, and or a certified copy thereof.

Policy No. _____ Company _____ Exp. Date _____

- Certified copy is hereby furnished.
- Certified copy is on file with the Building Department.

Date _____ Applicant _____

I you do not intend to employ any person so as to become subject to the Workmen's Compensation Law, complete the following:

4. CERTIFICATE OF EXEMPTION FROM WORKMEN'S COMPENSATION INSURANCE — I certify that in the performance of the work for which this permit is issued I shall not employ any person in any manner so as to become subject to the Workmen's Compensation Laws of California.

Date _____ Applicant _____

NOTE: If, after making this Certificate, you should become subject to Workmen's Compensation provisions of the Labor Code, you must forthwith comply or the permit shall be deemed revoked.

EL DORADO COUNTY BUILDING DEPARTMENT

APPLICANT TO COMPLETE THIS SECTION

APPLICANT TO COMPLETE THIS SECTION

Name: JOHN GRANAM ENT INC
 Assessor's Parcel No. 25-312-121
 Address: 1540 HORACE GREELEY

Plan Check No. _____
 Bldg. Permit No. 19487T

Energy Calculation Worksheet

<u>Building Summary</u>	<u>Floor Sq. Ft.</u>	<u>Exterior Glazing Sq. Ft.</u>
First Floor Living Space	<u>700</u>	<u>69</u>
Second Floor Living Space	<u>700</u>	<u>60</u>
Third Floor Living Space		
Total Floor Living Space		
Other (Specify)		
Garage		

NOTE: All building square footage figures are to be calculated to outside of exterior walls.

Building to be Heated ONLY Heated & Cooled

Type of Heating/Cooling System; Forced Air

The above information is provided as part of the required permit application data. I hereby declare under penalty of perjury that the information provided is complete and correct.

Signature [Signature] Date 10-12-85

The following form lists the required insulation for your project. When completed and signed, it may be used for the State Required Insulation Installation Certificate. It must be posted (fixed) on the job site when the Final inspection is made. (Other forms are acceptable.)

- All exterior openings weather-stripped.
- Windows: Dual glazed (U=0.7 max.) Required Not Required
- Walls: R value 19 Type Batts
- Floor: R value 19 Type Batts
- Ceilings: R value 30 Type Batts
- Other (Specify) _____

I hereby declare under penalty of perjury that all required items as noted have been installed in accordance with State Energy Requirements contained in the California Administrative Code, Title 25.

Signature of Applicator [Signature] State License Number 360461
 Builder _____
 Owner _____ Date 10-12-83

CAPABILITY
 LEVEL 7
 COVERAGE 30%
 LOT SIZE 6000 SQ FT
 ALLOWED 1800 SQ FT

APPROVED
 Omissions & Errors on Plans
 shall not be valid and all codes

DRAWN
STEVE
 916-04

DEC 1 1982

APPROVED
 EL DORADO COUNTY
 PLANNING DEPARTMENT
 DATE 11/24/82
 BY [Signature]
 THE APPROVAL OF THIS
 PERMIT IS MINISTERIAL AND
 NOT SUBJECT TO C.E.Q.A.

and to be met by compliance with
 Insp [Signature] Permit # _____

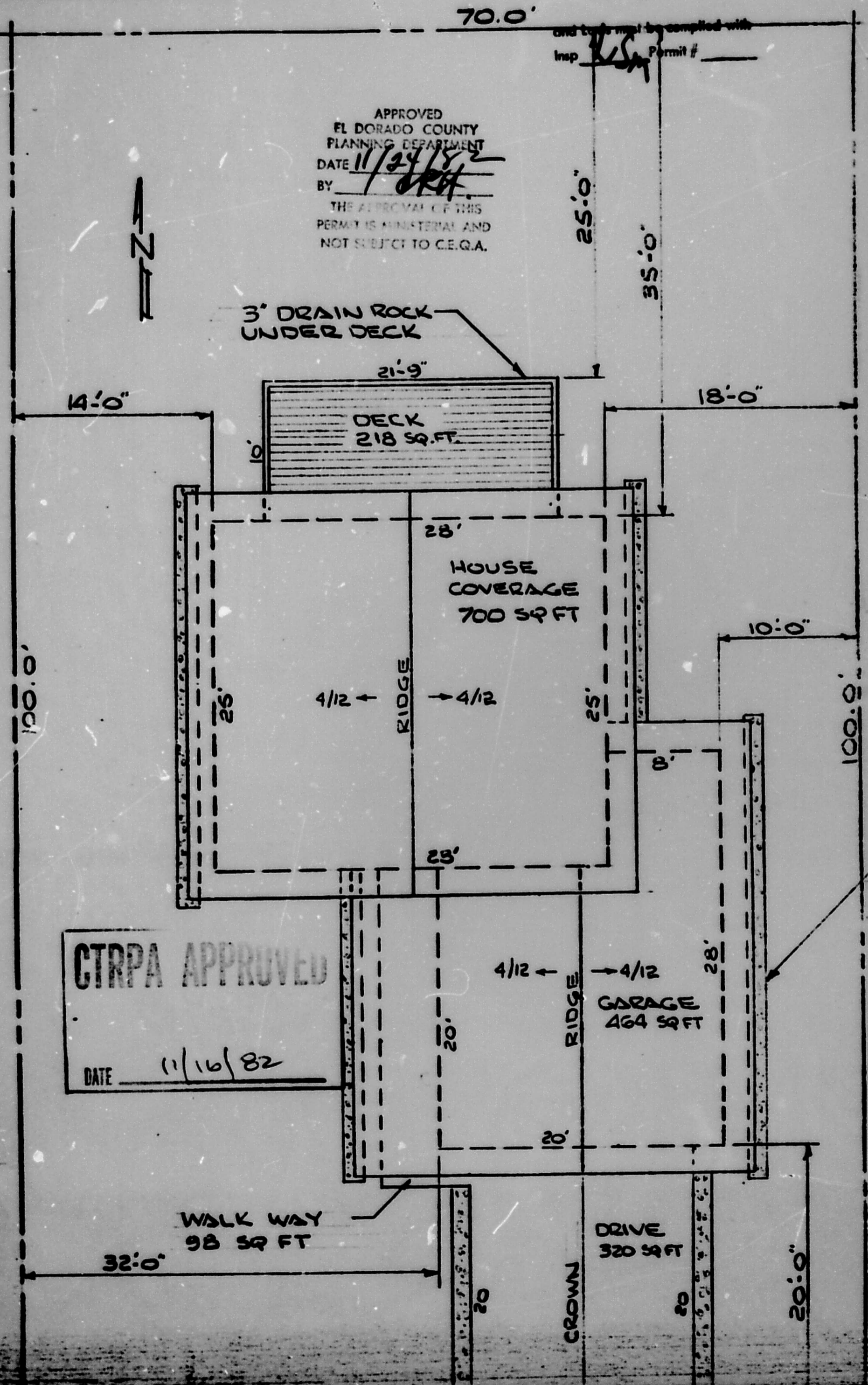

CTRPA APPROVED
 DATE 11/16/82

11-18-82.

JOHN GRANHAM

SO LAKE TAHOE

SNOW LOAD = 125 PSF

GARAGE DOOR HDR

TRUSS ROOF - 2' OV'HANG L.L. = 125 x 3 = 375 PLF
 D.L. = = 10 "
 BEAM = = 12
 TOTAL LOAD = 397 PLF

$$S = \frac{1.5 \times 397 \times 16.25^2}{1500 \times 1.15} = 91.19 \quad (4 \times 14 = 102.41)$$

$$V = 397 \times (8.125 - 2.33) = 2301$$

$$A = 1.5 \times \frac{2301}{95 \times 1.15} = 31.6 \quad (4 \times 14 = 46.38)$$

$$F_{c \perp} = 397 \times 9.125 = \frac{3226}{2 \times 1.5 \times 3.5} = 307.2$$

APPROVED
 Omissions & Errors on Plans
 shall not be valid and all codes

DEC 1 1982

and laws must be complied with
 Insp WJM Permit # _____

C. W. "CHUCK" NORGARD
 CONSTRUCTION CONSULTANT
 P. O. BOX 768, POLLOCK PINES, CA. 95726
 916 644-1262

WINDOW HDR - MAX SPAN = 6.5' - 1ST FLOOR
 2ND FLOOR LOAD = L.L. = 40, D.L. = 8, T.L. = 40 PSF
 ROOF LOAD = LL = 125, DL = 10, T.L. = 135 PSF

TOTAL LOAD = FL = 48 x 5.375 = 258 PLF
 RL = 135 x 12.5 = 1687 PLF
 WL = = 40 PLF
 RAIN = = 17 PLF
 TOTAL = 2002 PLF

$$S = \frac{1.5 \times 2002 \times 6.5^2}{1350} = 93.98 \quad (6 \times 12 = 121.23)$$

$$V = 2002 (3 - 952) = 4008$$

$$A = 1.5 \times \frac{4008}{85 \times 1.15} = 62.73 \quad (6 \times 12 = 63.25)$$

$$A = F_c \perp = 2002 \times 3 = \frac{6006}{385} = 15.6 \quad (2 - 2 \times 6 = 8.25 \times 2 = 16.5)$$

APPROVED

Omissions & Errors on Plans
 shall not be valid and all codes

DEC 1 1982

and Laws must be complied with

Insp WJH Permit # _____

LIVING ROOM BEAM - FLOOR LOAD ONLY

$$\text{TOTAL LOAD} = 50 \text{ PSF} + \text{BEAM} - R$$

$$\text{T.L.} = 50 \times 12.5 + 22 = 647 \text{ PLF}$$

$$S = \frac{1.5 \times 647 \times 16^2}{1600} = 155.28 \quad (6 \times 14 = 167.06 \times 987 = 164.89)$$

$$R = r_2(A-150) = .08 \times 50 = 4\% = 1.6 - \text{L.L.} = 38A$$

$$V = 602(8 - 1.167) = 4113$$

$$A = 1.5 \times 85 = 72.58 \quad (6 \times 14 = 79.25)$$

$$\Delta = \frac{16 \times 12}{240} = .53$$
$$\frac{1}{240} = .8$$

$$\text{act } A = 22.5 \times \frac{480 \times 65536}{1.6 \times 10^6 \times 1127.67} = .39$$
$$\frac{602}{480} \times .39 = .49$$

$$F_c \perp = 602 \times 8 = \frac{4816}{A = 385} = 12.5 \quad (2 - 2 \times 6 = 8.25 \times 2 = 16.5)$$

APPROVED
Omissions & Errors on Plans
shall not be valid and all codes

DEC 1 1982

and laws must be complied with
Inspr USA Permit # _____

SOUTH TAHOE PUBLIC UTILITY DISTRICT

Application For Sewer Units and Connection

FOR OFFICE USE
 17292
 11-23-82
 1982 Allocation

Existing James McGuire Parcel #23-561-211

Sold & T/F to:
 Made new changes on complete

OWNER RECORD James McGuire

MAILING ADDRESS P. O. Box 872

CITY Terra Bella, Ca. 93270 STATE _____

LOT NO. L 44 BLK. NO. _____

STREET George Greeley

TRACT Sierra Meadows #2

PARCEL NO. 25-312-171 Grid 0-88

ASSESS NO. _____

SEWER CONTR. _____

WATER APP. YES Collect \$1,075.00

D.B.A. _____

	RESIDENCE	COMMERCIAL
		FIXTURE UNITS
KITCHEN	1	
TOILETS	2	
MINIMUM		
OTHER		
TOTAL UNITS	3	+ 5 =
SERVICE CHARGE	\$205.20	
PERMIT FEE	\$ 25.00	
SADDLE FEE		
CONN. FEE	PD. 4-26-82 \$3,990.00 by McGuire	
TOTAL CHARGE	<u>3990</u>	\$4,220.20 Total

Customer's agent advised of water fee's
 Said Customer would be advised that he could pay water
 I represent and/or agree: next Spring but at existing rates then.

- I am the legal owner of record of the parcel of real property referred to in this application. A copy of my Deed of Record is submitted with this application.
- The number of plumbing fixtures specified will not be increased, the location of the plumbing fixtures specified on the construction plans submitted with this application will not be changed, and the sewer unit use specified in this application will not be increased, without an amended application and an amended permit issued therefore.
- In the event of any violation of representations and agreements in this application or conditions in any permit issued pursuant thereto, the South Tahoe Public Utility District may secure Court order requiring construction, occupancy and use of the parcel of real property to cease until there is compliance with said representations and agreements.
- All attorney fees, Court costs, administration, and inspection charges incurred by the District in connection with securing compliance with said representations and agreements in this application and any permit issued shall be assessed as charges against said parcel of real property.
- The legal owner of said parcel shall be responsible for all acts performed by the owner or his agent in connection with the application and permit issued pursuant thereto.
- The representations and agreements in said application and any permit issued pursuant thereto shall be binding upon the assigns and successors of the legal owner.
- All of the provisions of any ordinance of the South Tahoe Public Utility District now in effect, or hereinafter in effect, or hereinafter amended, regulating the use of public and private sewers, the installation of sewer laterals and public sewer main extensions, providing for the employment of a sanitary inspector, providing permits and fixing fees for the installation of sanitary sewer laterals and regulating plumbing, drainage and sewerage in the South Tahoe Public Utility District shall be complied with on said parcel of real property.
- After rough plumbing on the premises has been completed, there shall be no further construction until the District staff has inspected the rough plumbing and verified compliance with the application and permit issued pursuant thereto.

CTRPA TRPA LAHONTAN

CONFORMANCE FORM

Placer County _____ El Dorado County City of SLT _____ Mapped _____

Description of Project Sing Fam Res

NAME OF PERSON AUTHORIZED TO REPRESENT THE PROJECT AND TO WHOM ALL CORRESPONDENCE

IS TO BE SENT: JOHN S. GRAHAM Phone 5410431

MAILING ADDRESS: Po Box 9555 City SLT zip 95731

OWNER(S) OF RECORD: AGUSTIN & GRACE CHACON Phone 1-209-535-4979

MAILING ADDRESS: Po Box 872 9571 Road 239 City TENAYA BATH (alt) zip 93270

LOCATION OF PROPERTY:

Lot No. 44 Block No. _____ Subdivision SIGARRA MEADOWS #2

Street Address HOAKE CREEK AVE Cross Street _____

Assessor's Parcel No. 25-312-17

STANDARDS

Land Use District LDR Parcel Area 6000

Land Capability Classification 7 Land Coverage Authorized 1800

Soil Type EFB Land Coverage Existing 0

Slope of Building Footprint _____ Land Coverage Proposed 1800

Building Height Allowed (include additional height gained with slope allowance, if used) _____ Land Coverage Removed 0

Building Height Proposed 25' Net New Land Coverage 1800

Building Height Proposed 25' Total Land Coverage 1800

The dates or periods of time during which the proposed activity shall be occurring: From MAY 83 To _____

I hereby certify under the penalty of perjury that the information submitted here and on the submitted plot plan and building elevations is true and correct to the best of my knowledge and that all conditions of approval as required will be met at all times. Any modification of this project shall be reported to the TRPA, the CTRPA, and Lahontan.

[Signature] 10-25-82
Signature of Applicant Date Signature of Owner Date

FOR OFFICE USE ONLY

Date Received: 10/25/82 Origin of Sewer Permit _____
Filing Fee: \$ 120⁰⁰ Receipt No. 2441
Water Quality Mitigation Fee: _____ Receipt No. _____
Security: _____ Receipt No. _____
Field Check Required: _____ Date Completed: _____

Field Notes:

CONDITIONS OF APPROVAL:

1. See Standard Conditions of Approval (attached)
2. A Security in the amount of \$ 1200⁰⁰ shall be posted with the CTRPA -- this security is refundable upon satisfactory compliance with all Conditions of Approval, including establishment of vegetation. Securities will be held for up to three years.
3. Payment of \$ 750⁰⁰ for the TRPA Water Quality Mitigation Fund. This payment is not refundable.
4. Temporary and permanent erosion controls and site rehabilitation will be installed as shown on site plan.
5. Provide vegetation protection fencing around all vegetation within 30' of construction site

This project has been reviewed by CTRPA, TRPA and Lahontan as required by all applicable Plans and Ordinances and is found to be in conformance with these regulations and is hereby approved subject to the above conditions.

CTRPA Approval: Jason Bell 10/28/82
Name Date
TRPA Approval: Mark Seltzer 11/2/82
Name Date

Lahontan Approval: Contracted to CTRPA and TRPA

County of El Dorado

BUILDING DEPARTMENT



360 Fair Lane — Placerville, CA 95667
Phone (916) 626-2511

South Lake Tahoe Office

1359 Johnson Blvd. - P.O. Box 14506
South Lake Tahoe, CA 95702
Phone (916) 544-1564

SEWER CONNECTION TRANSFER PROPOSAL

	Secondary Parcel (From) (Allocation Applicant)	Primary Parcel (To)
Owner's Name	<u>JAMES McGUIRE</u>	<u>AUGUST CHALON</u>
Address	<u>4203 Apollo Circle</u> <u>Union City, CA 94587</u>	<u>C/O ALBERTA CROOK</u> <u>Aspen Realty 541-6630</u>
Assessor's Parcel #	<u>23-561-21</u>	<u>25-312-17</u>
Lot/Street	<u>HAZEL #51</u>	<u>Position Lot 44 Haven Grady</u>
Subdivision	<u>Tahoe Terrace</u>	<u>Sierra Meadows #2</u>
Zoning	<u>LDR</u>	<u>LDR</u>
Land Classification	<u>Class 7</u>	<u>Class 7</u>

AGENCY APPROVALS: Applicant has complied with the following:

- California Tahoe Regional Planning Agency
- South Tahoe Public Utility District
- Tahoe City Public Utility District
- City of South Lake Tahoe (If transferring from City)
- El Dorado County Building Department

See Letter
LD 091752
N/A
N/A
EL DORADO COUNTY BUILDING DEPT.

This is not a building permit application. All approvals, and proof of primary parcel ownership, for the specific proposed construction project must be submitted with the building permit application.

California Tahoe

916/541-6770

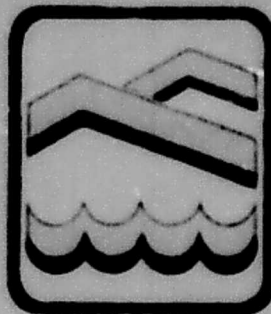

Regional Planning Agency

P.O. Box 14467 So. Lake Tahoe, CA 95702

September 15, 1982

Bill Olin
P.O. Box 18048
South Lake Tahoe, CA 95706

RE: APN 23-561-21 Transfer to
APN 25-312-17

Dear Mr. Olin:

The California Tahoe Regional Planning Agency (CTRPA) has determined that the property located at APN 23-561-21 is located within a Development Priority Area* and a Land Capability Class 4-7. The standards and requirements adopted by the Regional Agencies allow development on these types of parcels.

At your request, the Regional Agencies have reviewed the property located at APN 25-312-17 as a possible transfer site. An on-site inspection of this parcel was conducted and it has been confirmed that the parcel is located in a Development Priority Area and that it is located in a High Land Capability District (Class 7). The CTRPA Regional Plan allows the transfer of development allocations from high to high land capability areas; therefore, the CTRPA supports this transfer.

Should you have any questions, please contact the CTRPA office.

Sincerely,

Mark Seltenrich
Assistant Planner

*Development Priority Area - Any area in Placer or El Dorado Counties which is serviced by at least three of the following infra-structural facilities: 1) paved road; 2) sewer; 3) water; 4) electricity.



SOUTH TAHOE PUBLIC UTILITY DISTRICT

PRESIDENT
JAMES R. JONES

Sewer . 1950 . Water
P.O. Box AU South Lake Tahoe, California 95705
1275 Meadow Crest Drive

A PUBLIC AGENCY
Phone (916) 544-6474

DIRECTORS
WALTER "NEAL" OLSON
LORRENE KASHUBA
MICKEY MADDEN
JOHN WYNN

September 17, 1982

TO WHOM IT MAY CONCERN:

It has been determined that the transferring of the allocated right to connect from Parcel # 23-561-211 to Parcel # 25-312-171 for August Chacon will not increase the flow to the SOUTH TAHOE PUBLIC UTILITY DISTRICT's treatment system.

Very truly yours,

SOUTH TAHOE PUBLIC UTILITY DISTRICT

Bob E. Eppler
Bob E. Eppler
Customer Relations

McGuire to Chacon

BE:1b

DATE October 28, 1985

FINAL
11-26-85

NUMBER ~~20788~~

25-312-17

ADDRESS

LOCATION

1540 Horace Greeley

OWNER

Agustin Chacon

BUILDER

Owner

TYPE OF STRUCTURE

Auning Over Deck

REMARKS

INSPECTIONS:

Temp. power:

P.G.E. Notified:

Plot Plans:

Septic final:

Health Dept. I.D. finalized:

Permit released: Oct. 28, 1985

Final all:

EL DORADO COUNTY COMMUNITY DEVELOPMENT DEPARTMENT
BUILDING DIVISION

CONSTRUCTION PERMIT

T 20788

Bldg Plumb Elec Mech Gas Sewage Mobile Home Site

Date October 28, 1985
 Owner Agustin Chacon
 Address P.O. Box 18724
 City & State So. Lake Tahoe, CA
 Zip 95702 Telephone (916) 541-1620
 Contractor Owner
 Address _____
 City _____
 Zip _____ Telephone _____
 Contractor's License No. _____ Class _____
 Workmen's Comp No. _____
 Lending Agency _____
 Branch _____

Assessor's Parcel No. 25-312-17
 Section _____ Township _____ Range _____
 Parcel Map No. _____ County Rd _____
 No. of Bedrooms _____ Perm. Test _____
 Water Source _____ Supplier _____
 Public Sewer _____

PLANNING DEPARTMENT USE	
Lot Size _____	Zone _____
Min. Setbacks: FR _____ RS _____ LS _____ R _____	
House No. _____	
School Dist. _____	
Super. Dist. _____	C.T. _____
Variance or Spec. Use No. _____	Date ____/____/____

DRIVING DIRECTIONS 1540 Horace Greeley Ave. (Hank Monk - Black Bart)

Permission is hereby granted to build, occupy and use as specified, the building or structure listed below:

DESCRIPTION	GROUP & DIV.	TYPE RATING	SQUARE FEET	COST/SQ.FT.	VALUATION
<u>Auning-over</u>	<u>Deck</u>				\$ <u>800.00</u>
_____	_____	_____	_____	_____	_____
_____	_____	_____	_____	_____	_____
_____	_____	_____	_____	_____	_____
_____	_____	_____	_____	_____	_____
_____	_____	_____	_____	_____	_____
Type of Heating _____			Data Code _____	Total Valuation \$	<u>800.00</u>

Remarks and Conditions:

THIS PERMIT EXPIRES TWO YEARS FROM ISSUANCE.
 NO PRIOR APPROVALS REQUIRED PER PLACERVILLE.

	Fees
CONSTRUCTION	\$ <u>20.00</u>
M.H. SITE	_____
SEWAGE	_____
ENCROACHMENT	_____
ISSUANCE	_____
PENALTY	_____
TOTAL	\$ <u>20.00</u>

RECEIPT NO. 66052

This Work Permit Authorized and permit issued by R. Goodrich Date 10-28-85 Clerk ct

DEED RESTRICTION CERTIFICATE

County of El Dorado

The undersigned declares that he has read and understands the deed restrictions and that the improvement herein applied for does not violate any private deed restrictions.

Dated: Oct. 25 - 85

Agustin Chacon
Owner's signature

Agustin Chacon

Print owner's name
Revised Jan. 1982



360 Fair Lane — Placerville, CA 95667

Phone (916) 626-2511

1359 Johnson Blvd. - P. O. Box 14506

So. Lake Tahoe, Ca. 95702

Phone: 544-1564

OWNER-BUILDER VERIFICATION

ATTENTION: PROPERTY OWNER

PLAN CHECK # _____

An "owner-builder" building permit has been applied for in your name and bearing your signature.

Please complete and return this information at your earliest opportunity to avoid unnecessary delay in processing and issuing your building permit. No building permit will be issued until this verification is received.

- 1. I personally plan to provide the major labor and materials for construction of the proposed property improvement (yes or no) yes.
- 2. I (have/have not) have signed an application for a building permit for the proposed work.

3. I have contracted with the following person (firm) to provide the proposed construction:

Name _____

Address _____ City _____

Phone _____ Contr.Lic.No. _____

4. I plan to provide portions of the work, but I have hired the following person to coordinate, supervise, and provide the major work:

Name _____

Address _____ City _____

Phone _____ Contr.Lic.No. _____

5. I will provide some of the work but I have contracted (hired) the following persons to provide the work indicated:

Name	Address	Phone	Type of Work

Property Owner's Signature [Signature]

Social Security number _____ Date Oct. 25, 85
bam/Eff. 7/1/80

EL DORADO COUNTY BUILDING DEPARTMENT
APPLICATION FOR CONSTRUCTION PERMIT

Plan Check Number _____
 Permit Number _____

APPLICANT TO COMPLETE

Date Oct. 25 - 1985
 Owner Agustin CHACON
 Mailing Address P.O. Box 18724
 City & State SO LAKE TAHOE
 Zip 95702 Telephone (916) 541-1620
 Contractor OWNER.
 Mailing Address _____
 City & State _____
 Zip _____ Telephone _____
 Class & License # _____
 Workmen's Comp. No. _____
 Lending Agency _____
 Branch _____

Assessor's Parcel No. 25-312-17
 Section _____ Township _____ Range _____
 Parcel Map No. _____ County Road _____
 No. of Bedrooms _____ Perc. Test _____
 Water Source _____ Supplier _____
 Public Sewer _____

PLANNING DEPARTMENT USE	
Lot Size _____	Zone _____
Min Setbacks: FR _____ RS _____ LS _____	Rear _____
House No. _____	
School Dist _____	
Super. Dist. _____	C.T. _____
Variance or Special Use No. _____	Date <u>1</u> / <u>1</u> / _____

PROPERTY ADDRESS and DRIVING DIRECTIONS: 1540 HORACE GREELEY AVE
HAWK MOUNTAIN - BLACK BART

DESCRIPTION OF WORK

Permit For: AWNING OVER PECK - Mobile Home Make _____
 Electric NONE Amps NONE Size _____ State Mfg. _____ Year _____
 Plumbing NONE Serial No. _____
 Type of Heating NONE License No. _____
 LCC # _____ For Period of _____

OWNER/CONTRACTOR/AGENT-SIGN ON REVERSE SIDE OF APPLICATION

FOR OFFICE USE ONLY

APPROVALS	APP. BY	DATE	OCC.	TYPE	SQ. FT.	COST	VALUATION
SEWER							
WATER							
PUBLIC WKS.							
CTRPA							
TRPA							
PLANNING							
						Total Valuation \$ <u>800.00</u>	

FEES	
Construction	<u>20</u>
M.H. Site	_____
Sewage	_____
Encroachment	_____
Issuance	_____
Penalty	_____
SUB TOTAL	_____
High School	_____
Elementary School	_____

Rec. By _____ Plans Approved By _____ Date _____ Plan Check Fee _____ Rec. No. 660052

TOTAL FEES 20

EL DORADO COUNTY BUILDING DEPARTMENT
APPLICANT'S DECLARATION

CONTRACTORS-OWNER/BUILDER

I hereby certify that I have read this application and that the information is correct. I agree to comply with all County Ordinances and State Laws relating to building construction.

1. LICENSED CONTRACTORS DECLARATION — I certify that I am licensed under provisions of Chapter 9 (commencing with Section 7000) of Division 3 of the Business and Professions Code, and my license is in full force and effect.

Date _____ Contractor _____

License Class & No. _____

2. OWNER-BUILDER DECLARATION — I hereby affirm that I am exempt from the Contractors' License Law, Business and Professions Code, (Section 7031.5) by one of the following:

(a) I, as owner of the property, will do the work myself without hiring any employees, and the building or structure is not intended or offered for sale. (Proof of sale or offering for sale of the structure by the owner-builder within one year is presumptive evidence that such structure was undertaken for the purpose of sale). Complete Section #4 below. (Section 7031.5)

(b) I, as owner, am contracting with local contractors to construct the project. (Section 7044)

(c) I, as owner of the property, will employ workers with wages as their sole compensation. Complete Section #3 below.

(d) I am exempt under Section _____ Reason _____

Justin Chacon

Date *Oct. 25, 1985* Owner _____

3. WORKMEN'S COMPENSATION INSURANCE — I hereby affirm that I have a certificate of Workmen's Compensation Insurance, and or a certified copy thereof.

Policy No. _____ Company _____ Exp. Date _____

____ Certified copy is hereby furnished.

____ Certified copy is on file with the Building Department.

Date _____ Applicant _____

If you do not intend to employ any person so as to become subject to the Workmen's Compensation Law, complete the following:

4. CERTIFICATE OF EXEMPTION FROM WORKMEN'S COMPENSATION INSURANCE — I certify that in the performance of the work for which this permit is issued I shall not employ any person in any manner so as to become subject to the Workmen's Compensation Laws of California.

Date *Justin Chacon* Applicant *Oct. 25, 1985*

NOTE: If, after making this Certificate, you should become subject to Workmen's Compensation provisions of the Labor Code, you must forthwith comply or the permit shall be deemed revoked.